

## Distribution Surge Arrester

Metal oxide arrester

Polymeric Housing

IEC 60099-4, Ed 2.0

Nominal discharge current: 10 kA

Line discharge class: 2

High current impulse 4/10  $\mu$ s: 100 kA

Energy absorption capability at

– Line discharge imp.: 6 kJ/kV Uc

Long Duration Ipeak 530 A

Continuous operating voltage

**Uc: 24 kV**

Rated voltage

**Ur: 30 kV**

Outdoor application

Rated short circuit current: 40 kA

Low Current 600 A

Non-shattering design

**OCP2-24** ☐ - ☐ ☐ ☐

Standard Creep S

Long Creepage L

Mounting

Ground Lead

Line Lead

## Dimensions

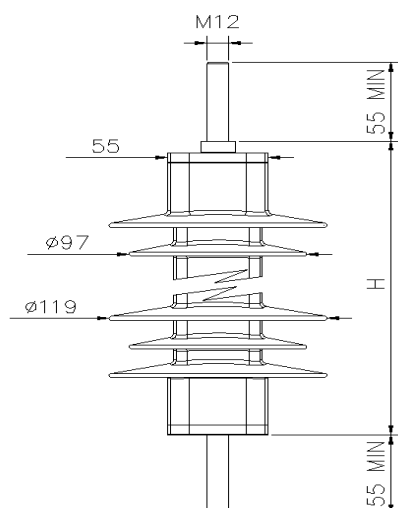

## Arrester Housing

		S	L
Impulse voltage	1,2/50 $\mu$ s kV	180	205
Power frequency voltage	-wet: kV	80	91
Overall length, (H)	mm	299	340
Flashover distance	mm	293	334
Creepage Length	mm	758	885
Weight	kg	3	3.5
No of Sheds:		11	13
Cantilever strength*	Nm	350	350
Pull strength*	N	2000	2000
Max. Torque M12*	Nm	50	50

## 100% Routine testing

- Residual Voltage
- Reference Voltage
- Partial Discharge

## Residual Voltages (kV)

Lightning current impulse 8/20 $\mu$ s			Steep lightning current impulse		Switching current impulse 30/60 $\mu$ s	
5 kA	10 kA	20 kA	10 kA	1/20 $\mu$ s	125 A	500 A
73.4	77.8	86.7	80.8		59.0	62.1

## Power frequency voltage versus time

1 Sec. TOV: 34.3 kV

100 Sec. TOV: 30.7 kV

## Marking

**Bowthorpe**

MO Surge Arrester

50/60 Hz

IEC 60099-4

Isc 40 kA

In 10 kA Class 2

OCP2-24

Uc: 24 kV

Ur: 30 kV

Manufacturing Year

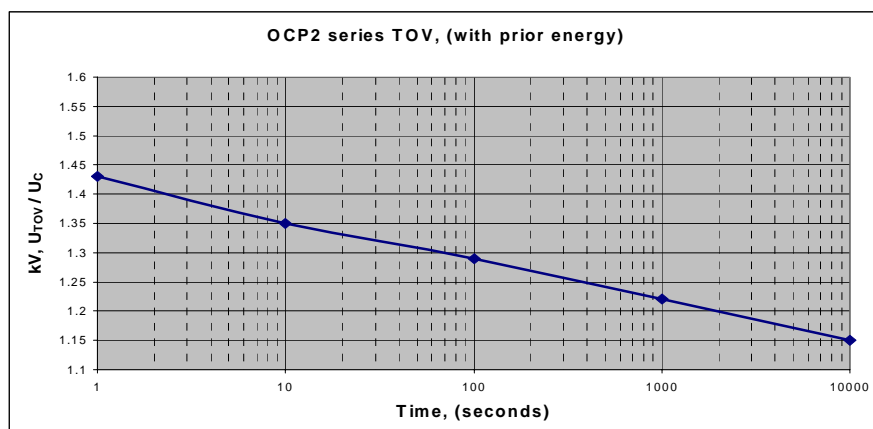
**MVSA-124-000-39/04-1**